

ATTACHMENT C

**ERSKINEVILLE GARDEN DRAFT
MANAGEMENT PLAN AND DESIGN**

OUR ERKO COMMUNITY COMPOSTING + COMMUNITY GARDENING + COMMUNITY

POLICIES + MANAGEMENT PLAN

1: Background and the Design and Implementation of Community Gardening & Composting at 54-56 Erskineville Road

2: Membership, Management and Maintenance for the long term

3: Membership Application Form

1: Background, Design and Implementation

The concept of Community Gardening and Composting began with the vision of local residents to activate a green space that is vacant land at 54-56 Erskineville Road, Erskineville. This land has been vacant and council owned for approximately 40 years. Community Gardening & Composting has enhanced the local neighbourhood in this area of Erskineville Road.

The use of the site for Community Gardening and Composting has been supported by local residents and also our local resident organisation Friends of Erskineville.

The Erskineville neighbours have enthusiastically embraced making use of a long-term area of vacant land to create a community area for gardening and composting. It is considered an enhancement to the streetscape and neighbourhood. Many residents live in small properties with little outdoor garden space and little opportunity to be involved in gardening. Residents living along Erskineville Road find the main road restrictive in a social sense. Residents of the shopfront properties have no front gardens at all, limited space at the rear, and limited sunlight. Older residents would enjoy the opportunity to help in a community garden space and spend social time.

There is potential to engage local businesses to look at reducing their waste going to landfill, and compost locally.

Type/structure of garden:

- the type/structure of the proposed garden will be both allotments and shared garden space as on the Site Plan, separate to this document
- the garden plot sizes are variable, with 900mm space between plots to allow access. No plots or structures to be within 1 metre of the boundaries of adjoining properties

Purpose of the community garden

- gardeners may have their own purpose, generally the purposes will cover: recreation and community building, food supply and health, education, household waste reduction
- a place to plant and learn about plants, foods and composting.
- a place for neighbours to come together, grow food, share their knowledge of plants and gardening, and socialise.
- a place young teenagers may develop some gardening skills and knowledge, and a sense of ownership
- a place for parents to bring children, and children may learn about plants and food
- the garden may be, by prior arrangement with the Committee available for visits by students, educational bodies and community groups.
- the Committee will seek to arrange suitable workshops, like composting and gardening, with qualified consultants (with fee if applicable).
- the Committee will arrange “open days” if requested, and invite visits from the community

Types of Plants

- bushfoods
- vegetables
- herbs
- small fruit trees

Biodiversity

- flowering plants and implementation of native stingless bee hives

Structures for the community garden site

- A small shelter area could be proposed, 8 sq. metres, for collecting rainwater
- Under the shelter, either some high bench, or low seating
- A proposed rainwater tank
- There is to be a 1 metre perimeter from the boundary/fenceline of the adjoining properties where no garden plots or structures will be placed (council requirement to allow spraying for pests)
- An space of approximately 900mm must be maintained between garden plots to allow access around and between plots

Composting

There are 2 “Aerobin” compost bins on the site. They are not placed together. To reduce pests, only 1 compost bin will be active, while the other remains empty. When the active bin becomes full it will be emptied, and remain empty while the other bin becomes active.

The “Green Waste” is placed in the area created with pallets. The Green Waste is used for mulching the areas outside of the garden plots, to help keep reduce the overgrowth of weeds

Training and skills

- The Green Living Centre is our local sustainability resource centre supported by Council, and located in Newtown at 218 King Street
- The Green Living Centre is free and open to the public and offers a variety of services such as a library, free workshops, practical ideas for everyday sustainable living, educational and business programs
- Council also offer a range of sustainability, gardening and composting information/worm farming sessions
- Assistance with advice is available from already established community gardens
- Assistance and advise is also offered from Council’s Community Gardens and Volunteer Coordinator

Aims and Philosophies, cooperation with and aims of Local Government

- educate and encourage residents to lead more sustainable lifestyles
- educate and reduce household waste by recycling waste organic matter through composting, worm farms and mulching
- enrich soils with recycled organic household waste
- harvest rainwater from shelter structure, for garden use
- greening of vacant land area, improving aesthetics and enhancing the local neighbourhood by productive use of limited available urban space
- promote a harmonious mix of the diverse approaches to sustainable gardening, and encourage a diverse range of plants
- promote nutritional health with a variety of edible plantfoods
- learn and appreciate the value of native bushtucker plants
- encourage the spirit of community participation, social networking co-operation, consultation, community pride and achievement

Water Conservation

- collecting rainwater from the shelter into a rainwater tank for garden use
- mulching on garden beds, to prevent moisture evapoaring and drying out the soil
- native bushtucker plants will be especially effective as they are naturally low water-use plants, and once established, they are very hardy too

Garden Funding

- to further enhance the site and visual appeal, endorsement from Council is being sought, and funding through the Grant Programs
- a modest annual plot fee will be considered to go towards ongoing costs

2: Membership, Management and Maintenance

- Membership is open to all members of the community interested in gardening
- Any new interested gardener will be made welcome and upon request will be given a Membership Application Form to complete. It is expected new members will agree to attend the monthly Working Bee, the first Sundays of the month from 10am, for consideration for a garden plot. A completed Membership Application Form may be submitted to the Committee at any time
- The Membership Application Form requires gardeners to have read this document and agree to the Policies, Requirements and Responsibilities
- If the new gardener is unable to attend the Sunday Working Bee then arrangements can be made for access on other days
- If there is no garden plot available then the new gardener's name will be placed on the waiting list for a garden plot when it becomes available.
- The new gardener will be encouraged to garden in the communal garden plots as shown on the most recent Site Plan, with the guidance of one of the members
- The Committee will manage administrative affairs to reflect the requirements of Council and Erskineville community members
- the Committee will discuss issues and make decisions
- a Code of Conduct will define the expected behaviour within the community garden site, and assist with resolving conflict

To ensure there are no problems with:

- Excessive noise - the site has no access to power, and it is not expected gardeners will require any noisy equipment. The community garden is not expected to be open after daylight hours. The gates are to be locked when the community garden is not occupied by gardeners
- Vandalism - The community garden will not be open to the general public, and the gates will be locked when the garden is not occupied. The aims of the Community Garden will be to encourage involvement and a sense of ownership within the local community, and this also minimises problems of vandalism
- Site aesthetics - the site will enhance the streetscape, showing passing pedestrians and traffic a garden of variety and visual appeal

Responsibilities, Maintenance, Occupational Health and Safety

- Standard garden tools only are to be used.
- Potential hazards are to be reported to the Committee for immediate rectification
- Members are to be careful and act safely at all times
- While on the Garden site and on council property, Members are to be responsible for their own well-being and that of others
- annual plot fees will be used for garden supplies, maintenance, social gatherings or other costs determined by the Committee
- A combination padlock is supplied by Council for the gates, and the combination will be available for gardeners and composters on the understanding they are in contact with the Committee, agree to the Policies, Requirements and Responsibilities, and receive information/communication via email (or other suitable form of information delivery)
- If a plot is not maintained for more than six weeks without explanation, the use of the plot will be reviewed by the Committee.
- If a gardener vacates their plot, the gardener may not transfer the plot, the plot will be re-allocated to an applicant on a waiting list, or to community plots if there is no waiting list
- If a gardener vacates their plot, they must not remove plants or soil from the plot
- Gardeners are responsible for their individual plots and maintaining the area around their plot, keeping the area free of weeds and rubbish, and any items that may obstruct pathways

- Organic practices apply - gardeners must avoid using chemicals and pesticides
- Gardeners must supply their own garden tools. As there is no storage allowance on site, garden tools and any other equipment must be carried in and out
- Rubbish must not be left at the Community Garden site. Rubbish must be carried out
- Gardeners and visitors must respect the gardens as community spaces, and not remove or harvest any plants or equipment without the plot owner's permission
- the Committee will arrange a working bee every month, on the first Sunday from 10am, to encourage community participation with weeding and tidying
- Animals, including pets, may not be brought onto the Community Garden site
- If a member goes against the spirit of this Policy their membership will be reviewed by the Committee.

OUR ERKO COMMUNITY COMPOSTING + COMMUNITY GARDENING + COMMUNITY

4: Membership Application Form 2013

Name:

Address:

Contact Number/s:

Email:

Nominated by:

Seconded by:

I agree to respect other members and their gardens.

I agree to be careful and act safely at all times, be responsible for my own wellbeing and that of others while on Council property.

I have received a copy of the Erskineville Road Community Garden Policies & Management Plan, dated February 2013. I have read and agree to comply with Policies, Requirements and Responsibilities outlined in this document

Signed

Date

Site Plan, 54-56 Erskineville Road, Erskineville

BOUNDARY 20-28 BALDWIN STREET

ONE METRE PERIMETER

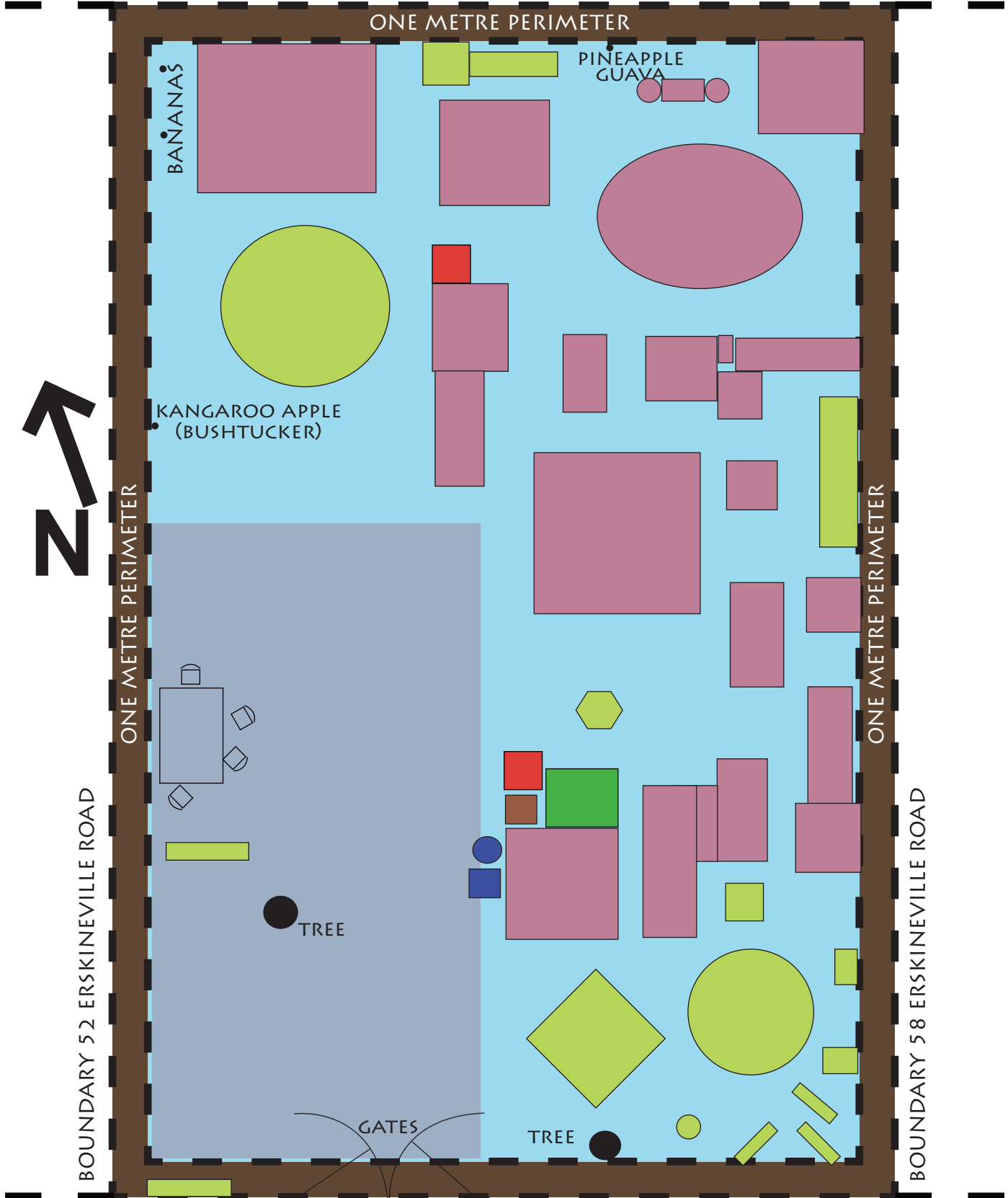

OUR ERKO COMMUNITY COMPOSTING + COMMUNITY GARDENING + COMMUNITY

- GREEN WASTE
- WATER BINS
- DRY (FOR COMPOST)
- COMMUNAL GARDEN PLOTS & PLANTERS
- EXISTING GARDEN PLOTS
- COMPOST BINS
- WORK & ACCESS AREA - NO PLOTS

DATE: FEB 2013

SCALE: N.T.S.

ATTACHMENT C